

Tête H 782



Universal Two Jaw Offset Pulling Head

INSTRUCTION SHEET.

DIMENSIONAL DATA (see Fig. 1)

- Stroke: up to 3/4"

CHOICE OF RIVETERS

- The Pulling Head is recommended to be used with the following Cherry Riveters:
 - G747:** very compact, light weight, 2200 Lbs force/ .437" stroke,
 - G704B:** high power, short stroke 3100 Lbs force/ .5" stroke
 - G746A:** very long travel 1850 Lbs force/ .875" stroke
 - G902:** very compact, long travel 1100 Lbs force/ .75" stroke.

Other riveters may be used with proper adaptors.

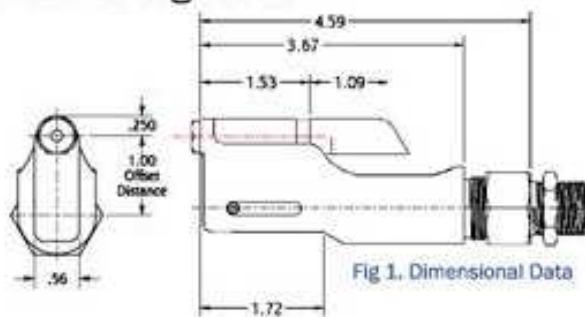

MOUNTING INSTRUCTIONS

- Attach Riveter to air source for correct piston positioning
- Thread the Pulling Head onto the Riveter; make sure that both internal and external threads are properly engaged.
- When threads are bottomed out, the head can be unthreaded up to 1 turn in order to achieve the desired head orientation.
- Lock into position by tightening the Jam Nut.
- Caution: Do not use thread locker (Example: Loctite™) on the adaptor and Jam Nut threads.

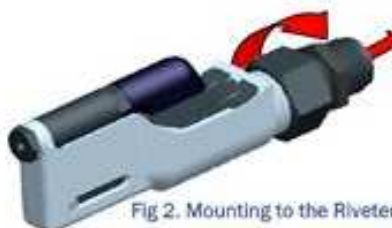

Fig 2. Mounting to the Riveter

OPERATING INSTRUCTIONS

Before use, make sure that:

- The Pulling Head is correctly mounted and the proper riveter is selected.
- Proper Air source is connected (see Riveter specification for recommended pressure).
- Make sure that the proper Nosepiece is used and that it is in good working condition. Use the "Nosepiece Selection Table" as a guide.
 - The head is provided with 782-456 Nosepiece.
 - Optional Nosepieces are available for different fastener types and size. Use the Nosepiece Selection Table to make the proper selection.

During Operation:

- Inspect the active area of the Nosepiece regularly.
- Keep the tool clean, especially the Nosepiece and Jaws:
 - Pay special attention when used with sealants and adhesives.
- If stem slippage occurs, the Jaws need to be either cleaned or replaced.

Nosepiece Selection Table

	PART NUMBER	INSTALLS THE FOLLOWING PRODUCTS / DIAMETERS
Included	782-456	Standard Nosepiece • CherryMAX: -4, -5 & -6 • CherryMAX: "AB": -4, -5, & -6 (except -6 aluminum) • Blindbolt "S" type: -04 & -05 • MBC Lock Creator: -4, -5 & -6
	782-6AL	CherryMAX "AB": -6 Aluminum
Optional Nosepieces	886-003	CherryLOCK "A" Code: -3
	886-004	CherryLOCK "A" Code: -4
	886-005	CherryLOCK "A" Code: -5
	886-006	CherryLOCK "A" Code: -6
	782-5BB	Blindbolt "U" Type: -05
	782-4MBC	Standard MBC: -4
	782-5MBC	Standard MBC: -5
	782-6MBC	Standard MBC: -6
	782-3	3/32" SPR and Pull Through Nut Plate Rivets: -3

MAJ : 02-18
 Vérif. : N.P.L
 Appr. : C . P

Distribution OPINDUS



Matériel conforme à la législation européenne

OPINDUS : 1, Rue Maurice Audibert 69800 SAINT PRIEST Tél : 04.78.21.73.14 - Fax : 04.78.21.73.01